

PIMA NORTE EXECUTIVE SUITES

36600 N. Pima Road, Bldg A, Suites 101 & 102 | Carefree, Arizona 85377

MOVE IN TODAY!



OFFICE CONDO FOR SALE OR LEASE

SUITE SIZES & PRICE:

Suite 101; ±669 SF

Sale - call for information

Lease* - \$18.50/SF NNN

Suite 102; ±727 SF

Sale - call for information

Lease* - \$18.50/SF NNN

*Term: 1 or 2 year lease - suites can be connected

CONSTRUCTION STATUS:

Complete

PARKING RATIO:

4:1,000 SF

For more info contact:

ERIC BUTLER

VICE PRESIDENT

480.776.0603

ebutler@logancommercial.com

BRET ISBELL

VICE PRESIDENT

480.776.0604

bisbell@logancommercial.com

480.860.6900 T
logancommercial.com



PIMA NORTE EXECUTIVE SUITES

36600 N. Pima Road, Bldg A, Suites 101 & 102 | Carefree, Arizona 85377

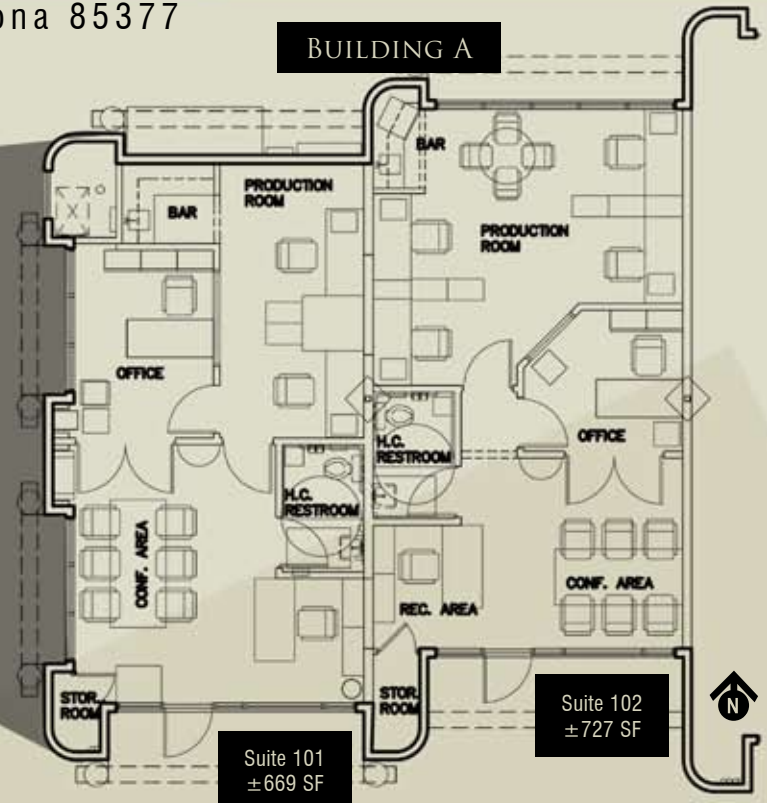
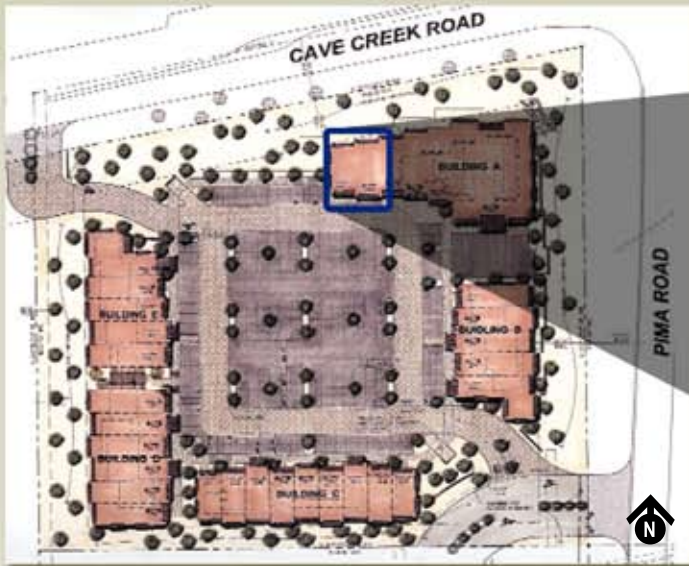

EXECUTIVE SUITE HIGHLIGHTS:

- Patterned marble floor throughout
- Mahogany interior doors and windows with top of the line door hardware
- Partial stone interior wall
- Special order decorative ceiling tile and interior light fixtures
- Top of the line plumbing fixtures
- Granite counter top Grade D with luxury faucets at kit/bar area throughout the executive suites

AREA HIGHLIGHTS:

- Beautiful Carefree location
- Located at the base of Desert Mountain
- Just minutes from Mirabel, The Boulders and Whisper Rock
- Near Skyranch Carefree Airport & Legend Trails
- Only professional center on Pima Road north of Pinnacle Peak

For more info contact:

ERIC BUTLER
VICE PRESIDENT

480.776.0603

ebutler@logancommercial.com

BRET ISBELL
VICE PRESIDENT

480.776.0604

bisbell@logancommercial.com



480.860.6900 T | 480.860.6904 F
9320 East Raintree Drive
Scottsdale, Arizona 85260
logancommercial.com